

SAMSUNG

ENGLISH

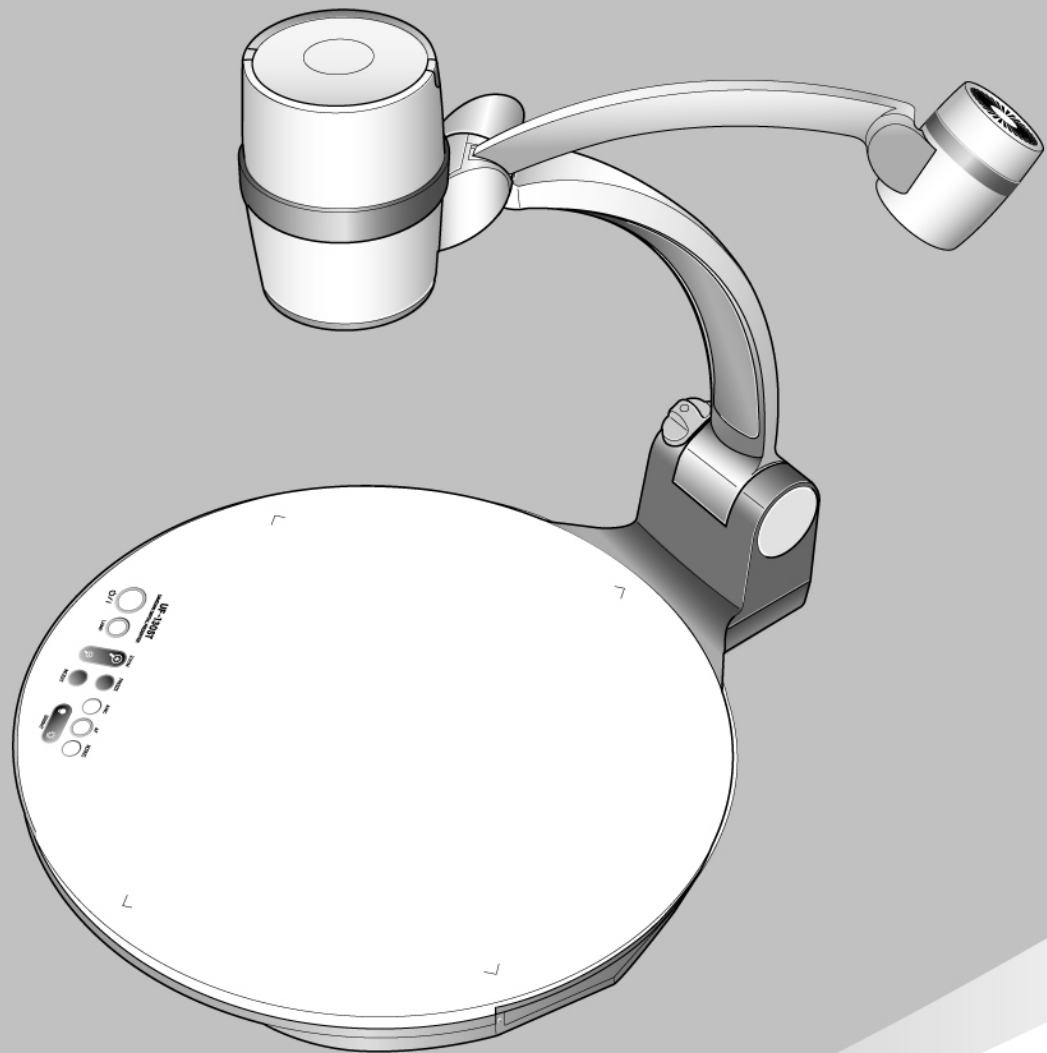

HIGH RESOLUTION DIGITAL PRESENTER

USER'S MANUAL

UF-130ST

Before attempting to operate this product, Please read the instructions carefully.
www.samsungpresenter.com

Special Features

- Thank you for purchasing this product.
This product is a high resolution digital document camera that can display a variety of materials to any display device that supports VGA or DVI inputs.

1.3 Mega pixel digital camera with 14X optical zoom and new generations of DSP chipsets deliver highest image quality and resolutions.

The UF-130ST camera design now includes a 1.32 megapixel Progressive Scan CCD plus updated DSP chipset to provide the ultimate in image quality at HD resolution 720P at 30FPS (frames per second) plus selectable standard SXGA and XGA outputs.

Innovative LED illumination

A newly designed flexible light arm incorporating both LED + Optics provides even illumination with no glare for unparalleled display of any subject matter.

Can control USB 2.0 and RS-232C

Especially by using USB, it is possible to view or store the real time image in a PC and control the function in a moment. Also it is possible to control the functions by using RS-232C port.

DVI port imbedded

By adopting DVI(Digital Video Interactive) output port UF-130ST presents vivid and noise-less images.

Remote controller is a standard feature

Remote controller is supplied as a standard feature for the product so that it can be manipulated from a distance. Thus it is very convenient during a conference.

Contents

Product features and structure

Safety precautions	4
Uses of digital presenter	6
Supplied accessories	7
Name and function of each part	8
Front side	8
Main control panel	10
Terminals at the back	11
Remote Control Features & Functions	12

Ready to use

Setup	14
Connecting to output device	15
PC Monitor, Projector or DVI supporting device	15
Desktop computer	16
Connection Computer	17
Using the presenter	18
To show the image received from external device	18
Adjusting your image	20

Before requesting service

Storage	23
Trouble shooting	25
Battery replacement	26
Specifications	27

Safety precautions

Follow these safety instructions when setting up and using your Digital Presenter:

1. Do not place the presenter on an unstable cart, stand, or table.
2. Do not use the presenter near water or sources of heat.
3. Use the type of power source indicated on the presenter. If you are not sure of the power available, consult your dealer or power company.
4. Place the presenter near a wall outlet where the plug can be easily unplugged.
5. Take the following precautions for the plug. Failure to comply with these precautions could result in sparks or fire:
Do not insert the plug into an outlet with dust present. Insert the plug firmly into the outlet.
6. Do not overload wall outlets, extension cords, or integral convenience receptacles. This can cause fire or electric shock.
7. Do not place the presenter where the cord can be walked on. It may result in fraying or damage to the plug.
8. Unplug the presenter from the wall outlet before cleaning. Use a damp cloth for cleaning. Do not use liquid or aerosol cleaners.
9. Do not block the slots and openings in the presenter case. They provide ventilation and prevent the presenter from overheating. Do not put the presenter on a sofa, rug, or other soft surface or in a built-in installation, unless proper ventilation is provided.
10. Never push objects of any kind through cabinet slots. Never spill liquid of any kind into the presenter.
11. Except as specifically explained in this User's Manual, do not attempt to service this product yourself. Refer all servicing to qualified service personnel. Opening or removing covers may expose you to dangerous voltages and other hazards.
12. Unplug the presenter during lightning storms or when it will not be used for extended periods.
13. Do not place the presenter and remote controller on top of heat-producing equipment or in a heated place, such as a car.
14. Unplug the presenter from the wall outlet and refer servicing to qualified service personnel under the following conditions:
 - When the power cord or plug is damaged or frayed.
 - If liquid has been spilled into the presenter, or it has been exposed to rain or water.
 - If it does not operate normally when you follow the operating instructions, or if it exhibits a distinct change in performance, indicating a need for service.
 - If it has been dropped or the case has been damaged.
15. This equipment is indoor use only.

FCC Compliance Statement

This equipment has been tested and found to comply with the limits for a class A digital device, pursuant to part 15 of the FCC Rules. These limits are designed to provide reasonable protection against harmful interference when the equipment is operated in a commercial environment. This equipment generates, uses, and can radiate radio frequency energy and, if not installed and used in accordance with the instruction manual, may cause harmful interference to radio communications.

Operation of this equipment in a residential area is likely to cause harmful interference in which case the user will be required to correct the interference at his own expense.

CAUTION

Random replacement of built-in battery by other types of batteries may cause explosion. The battery shall be replaced by the same battery. The used batteries shall be disposed carefully because they can cause environment pollutions.

Safety precautions



Eco RoHS compliant

Samsung Techwin cares for the environment at all product manufacturing stages to preserve the environment, and is taking a number of steps to provide customers with more environment-friendly products. The Eco mark represents Samsung Techwin's will to create environment-friendly products, and indicates that the product satisfies the EU RoHS Directive.



Correct disposal of batteries in this product

(Applicable in the European Union and other European countries with separate battery return systems.)

This marking on the battery, manual or packaging indicates that the batteries in this product should not be disposed of with other household waste at the end of their working life. Where marked, the chemical symbols Hg, Cd or Pb indicate that the battery contains mercury, cadmium or lead above the reference levels in EC Directive 2006/66. If batteries are not properly disposed of, these substances can cause harm to human health or the environment.

To protect natural resources and to promote material reuse, please separate batteries from other types of waste and recycle them through your local, free battery return system.



Correct Disposal of this product (Waste Electrical & Electronic Equipment)

(Applicable in the European Union and other European countries with separate collection systems.)

This marking shown on the product or its literature, indicates that it should not be disposed with other household wastes at the end of its working life. To prevent possible harm to the environment or human health from uncontrolled waste disposal, please separate this from other types of wastes and recycle it responsibly to promote the sustainable reuse of material resources.

Household users should contact either the retailer where they purchased this product, or their local government office, for details of where and how they can take this item for environmentally safe recycling.

Business users should contact their supplier and check the terms and conditions of the purchase contract. This product should not be mixed with other commercial wastes for disposal.

Uses of digital presenter

Conference

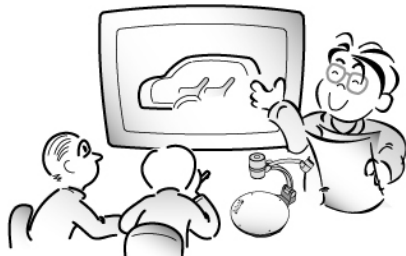

Detailed information in a report, form, table, etc. as well as a three dimensional object, such as a model, can be projected on a screen clearly that all the participants can focus on the same topic during a conference. Thus it is very helpful for an effective progress of a conference.

Education



It can be used as an audiovisual tool for printed materials, such as text books, as well as audiovisual materials, educational materials, and especially for students' art works.

Medicine and science areas

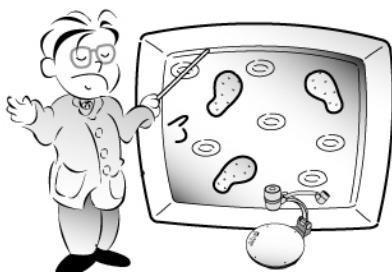

It is possible to present various visual data including slides and X-ray film etc. at a medical conference or a doctors' association in the order of file.

Advertisement and design areas

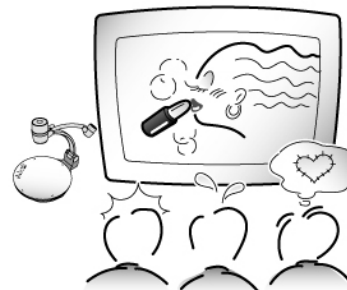

It is useful in design area where visualization is necessary. It is possible to project catalogs and slides, thus the effect of a job can be checked easily.

Demonstration or exhibition



By connecting to a large projector, it can produce dynamic images at a new product demonstration, an exhibition, or an event.

Supplied accessories

■ When you unpack your Digital Presenter, make sure that you have all these components.

User's Manual



DVI cable

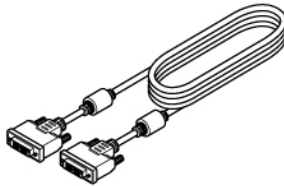

Remote control



Adapter

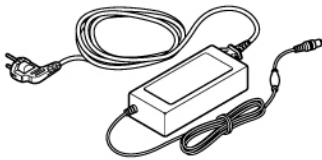

Lens cap

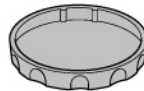

VGA cable

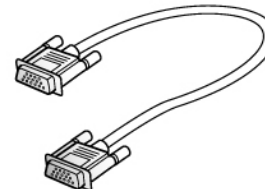

USB cable

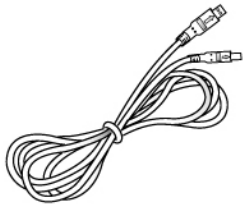

UF-130ST program

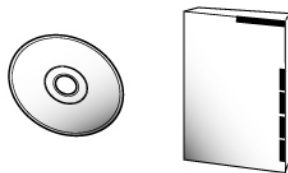

Dust cover

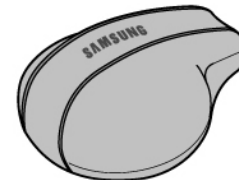

Carrying bag



USB Mouse



etc.

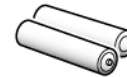

Option

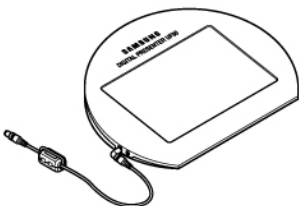

Supplied accessories

Name and function of each part

Front side

Name and function of each part

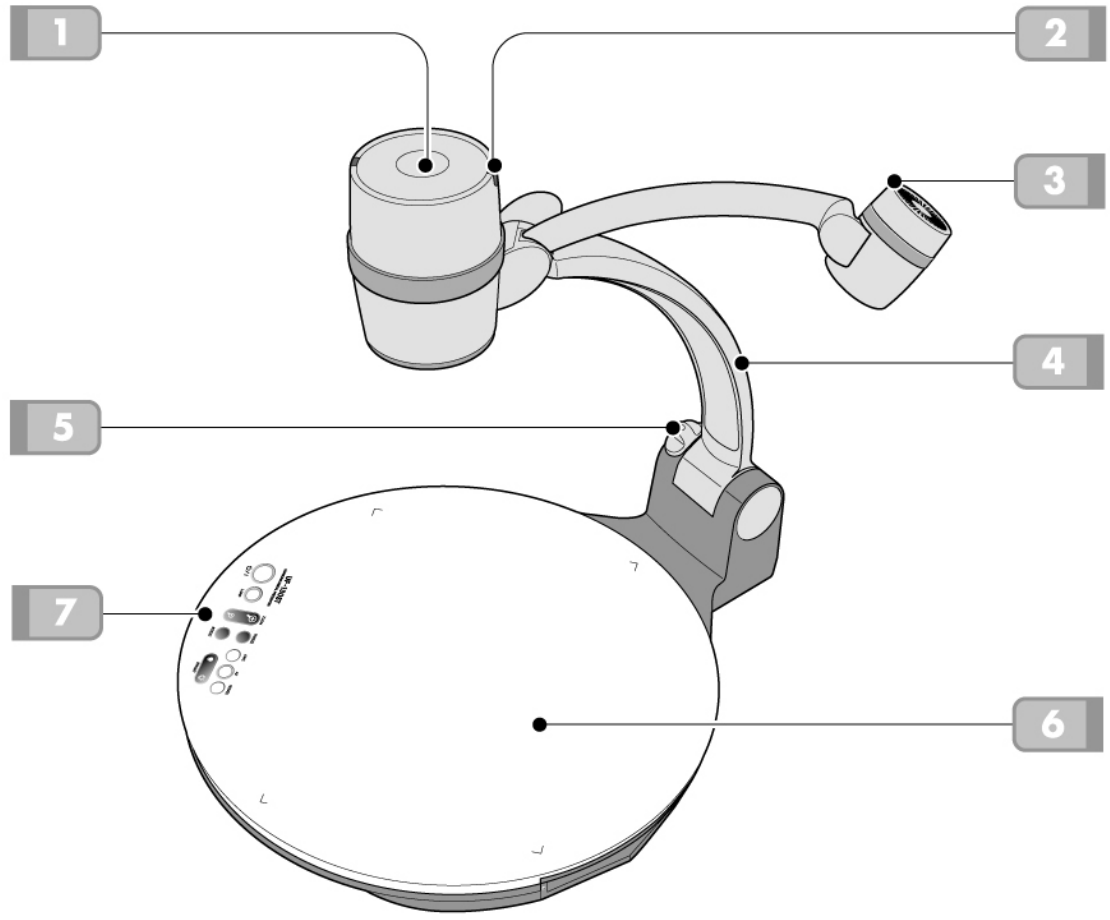

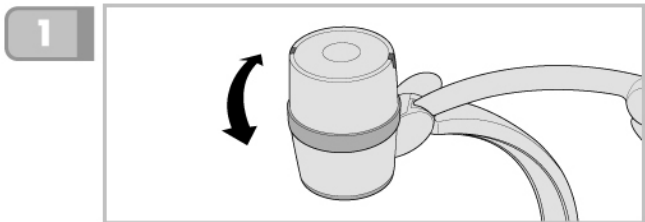
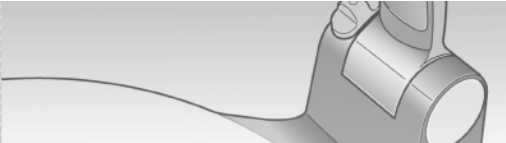

Lens

Can rotate to the front and back.

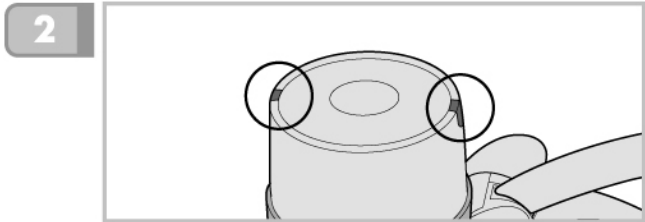

IR Sensor

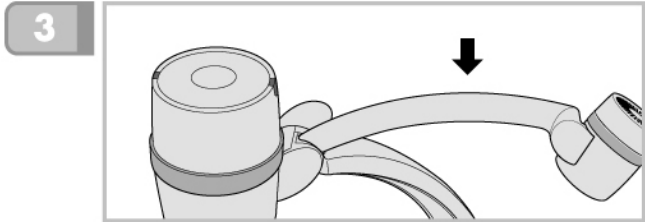

Lamp unit

(Upper lamp)

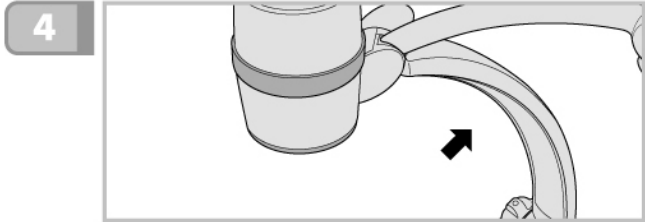

Main support

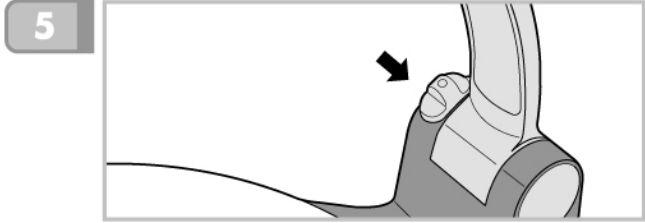

Main lock button

Press to raise and lower the main support arm.

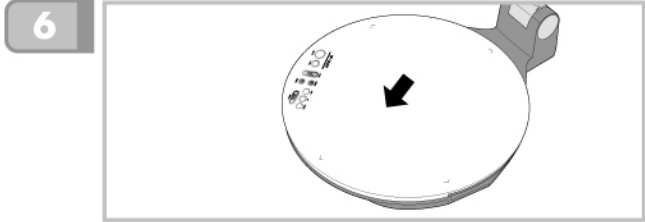

Document Stage

A4 document guides (indents) are provided on the stage.
(A4 Lightbox is Optional)

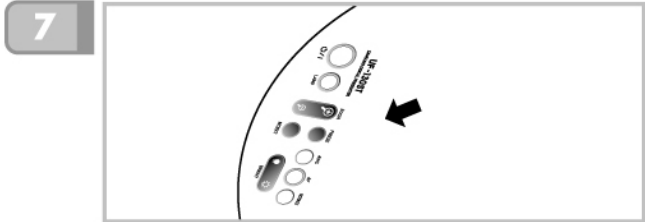

Main control panel

Name and function of each part

Name and function of each part

Main control panel

- The buttons on the main control panel can also be found on the remote control. These buttons perform the same functions.

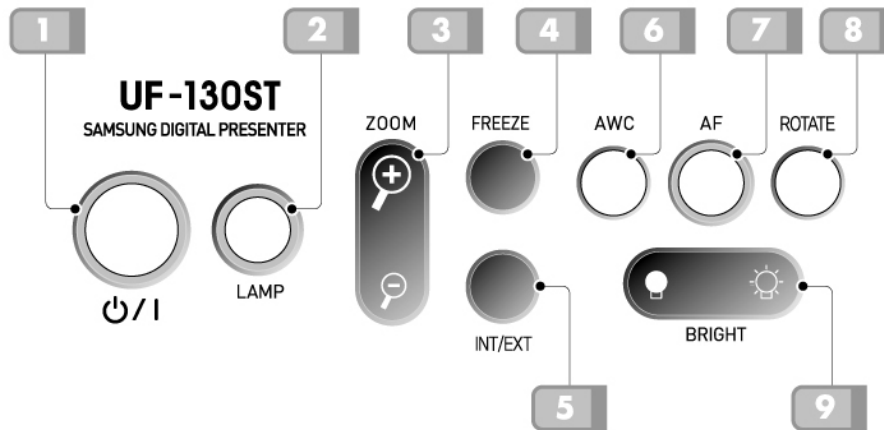

1 POWER

Press and hold for 3 seconds to turn off power.

2 LAMP

Use this to turn the upper lamp on or off.

3 ZOOM

Use this to control the size of an object projected on the screen.

4 FREEZE

Press once to Freeze an image, Press again to release.

5 INT/EXT

Allows to choose the signal inputs to be displayed.

6 AWC

Press to activate the auto white balance feature.

7 AF

Press to activate the autofocus manually.

8 ROTATE

Use this to rotate the image by 90°, 180°, 270°, 0°.

9 BRIGHT

Use this to control the brightness of the image.

Name and function of each part

Terminals at the back



1 POWER INPUT TERMINAL
Use this to connect the power cable. (DC12V)

2 LIGHTBOX POWER OUTPUT TERMINAL
When Lightbox is used you can connect the Lightbox cable to the INPUT terminal located next to the switch of the Lightbox.
DC 12V OUT, 0.6A

3 RS-232C: COMPUTER CONNECTION TERMINAL
Use this to connect RS-232C cable.

4 DVI OUTPUT
Connect this to the monitor or projector by DVI port.

5 VGA VIDEO OUTPUT
Connect this to the RGB input terminal of a PC monitor or a projector by supplied PC cable.

6 VGA VIDEO INPUT
Connect this to the VGA output terminal of another device by supplied PC cable.
When external input menu is selected, the image is shown through the VGA input terminal.

7 USB: COMPUTER CONNECTION TERMINAL
Use this to connect USB cable when transmitting image to a PC by USB port.

Name and function of each part

Name and function of each part

Remote Control Features & Functions

Name and function of each part

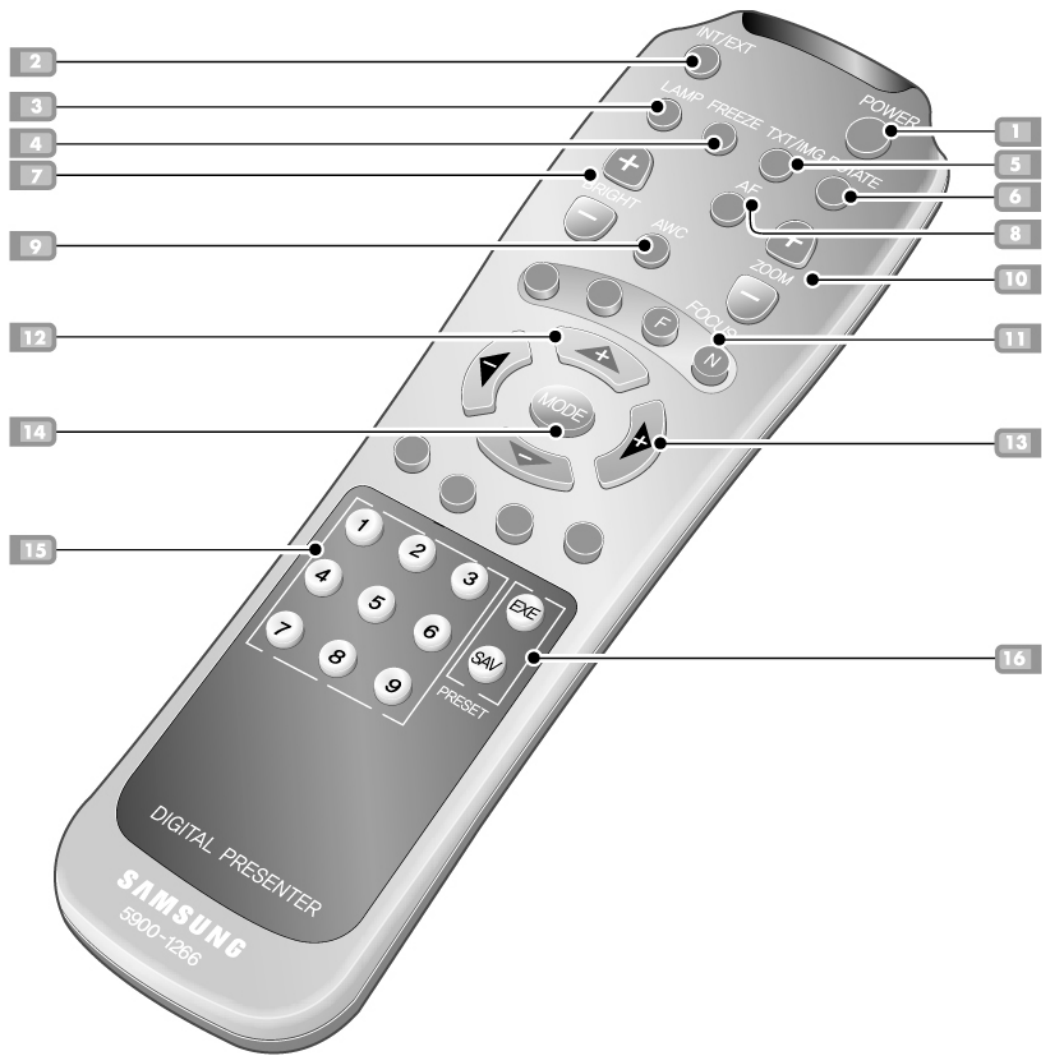

1 POWER

Turns power on or off.

2 INT/EXT

Allows to choose the signal inputs to be displayed.

3 LAMP

Turns the upper lamp on or off.

4 FREEZE

Keeps the current image on the screen.

5 TXT/IMG

Controls the sharpness of the output image. Switches for TEXT mode or IMAGE mode.

6 ROTATE

Use this to rotate the image by 90°, 180°, 270°, 0°.

7 BRIGHT + / BRIGHT -

- Increases the brightness.
- Decreases the brightness.

8 AF

Use this to adjust the focus automatically.

9 AWC

Adjusts color automatically.

10 ZOOM

Reduces or enlarges the image size on the screen.

11 FOCUS

Allows to focus on an object.

F: Used to focus on an object which is in the far distance.

N: Used to focus on an object being close.

12 RED

Adjusts the red color.

13 BLUE

Adjusts the blue color.

14 MODE

Change the resolution mode.
(1280x960/1024x768/1280x720)

15 NUMBER KEY

Run preset (Num1. ~ Num4.)

16 PRESET

Allow to save the customized user setting values or to activate the preset user setting.

Setup

1 Press the main lock button and raise the main support.

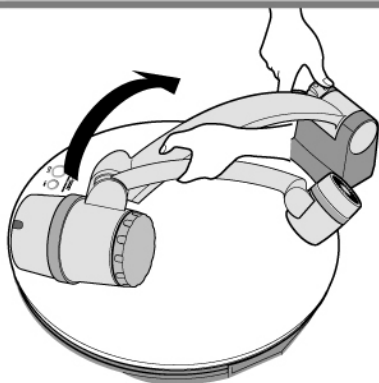

2 Turn the lens area to face downward.

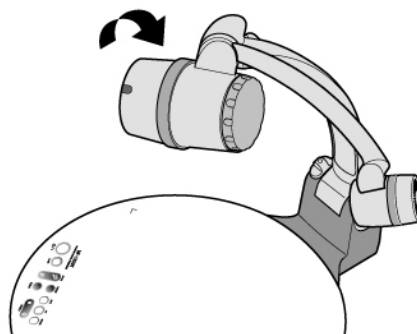

3 Remove the lens cap.

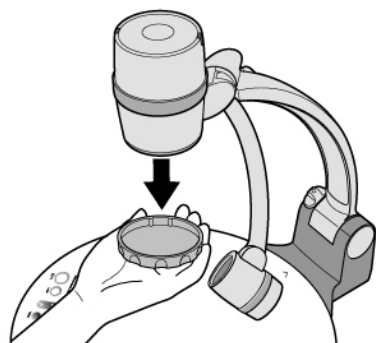

4 Unfold the lamp unit.

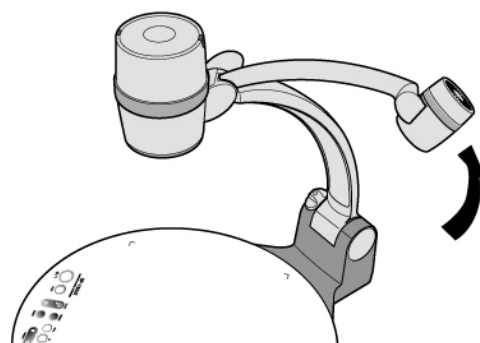

5 Put the plug into the outlet.

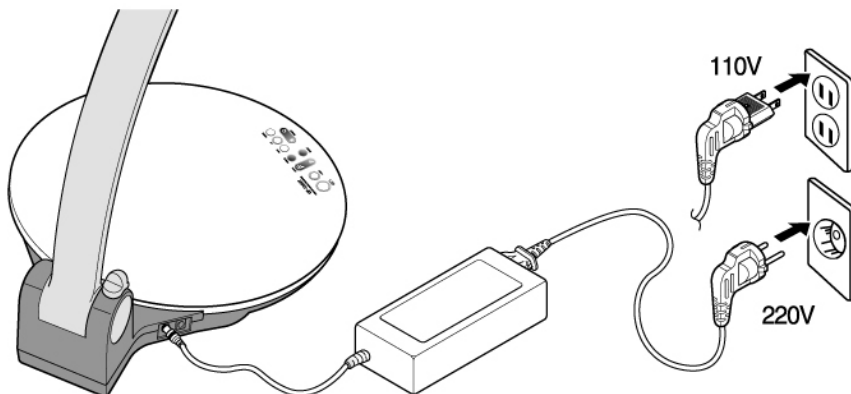

Setup

Connecting to output device

PC Monitor, Projector or DVI supporting device

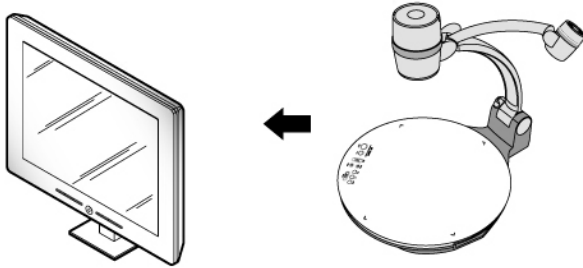

- Connect PC monitor, Projector and DVI supporting devices (Monitor or Projector) to this presenter to display the projected images using the PC monitor cable or DVI cable. Connect to the DVI input terminal.

Connection

Connect to the
VGA input terminal

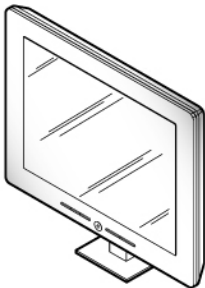

PC monitor, projector, etc

PC monitor cable

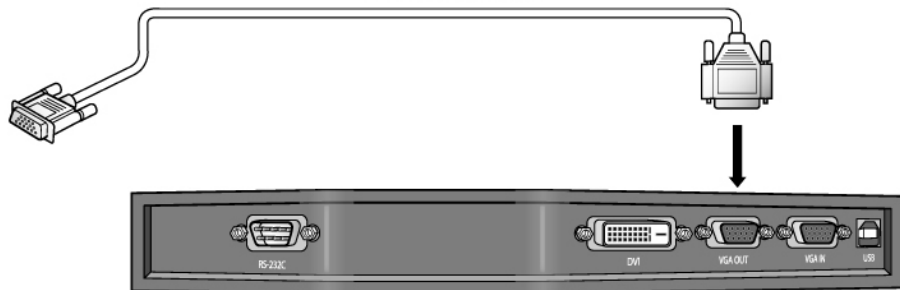

Digital Presenter

Connect to the
DVI input terminal



Monitor, projector, etc

DVI cable

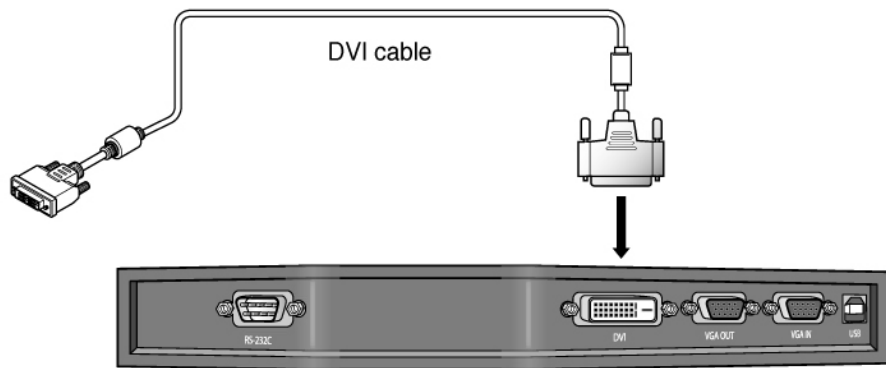

Digital Presenter

NOTE

Since the UF-130ST supports Dual output displays, both the DVI and VGA outputs can be connected to multiple displays.

Connecting to output device

Desktop computer

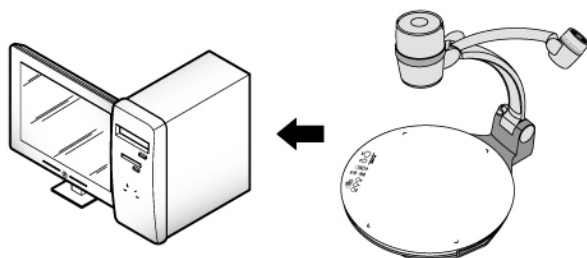

- Connect a desktop PC and the presenter using USB cable and install the supplied program. You can see the projected image on the PC monitor and control the image using the program.
- RS-232C connection is available for advanced user. If you connect a PC with RS-232C cable, you should set up your PC and make your own program to control the projected image on PC. Ask your dealer for further details.

USB connection

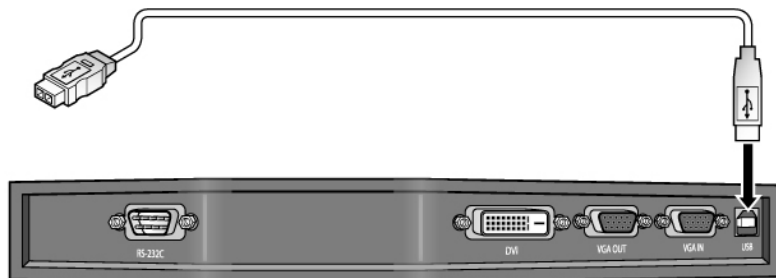
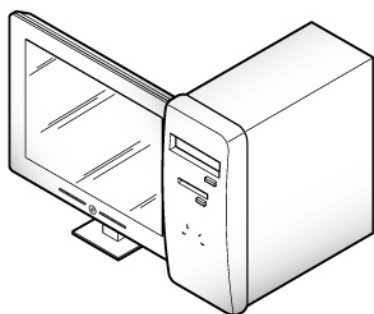

Digital Presenter

Connect to the USB port on your PC, then install the supplied UF-130ST program.

CAUTION

We recommend you to connect to USB port which is attached on computer main board. (It can make troubles in extended front-side USB port or USB hub without power in accordance with computers.) Be sure to use the USB cable shorter than 4.0 m.

RS-232C connection

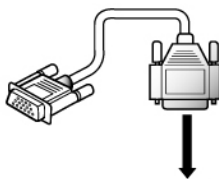
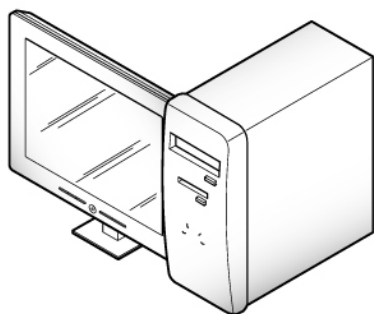

Digital Presenter

Connect the cable to the RS-232C terminal on your PC.

NOTE

RS-232C cable is not provided with the presenter. You can obtain one from your computer dealer.

Connecting to output device

Connection Computer

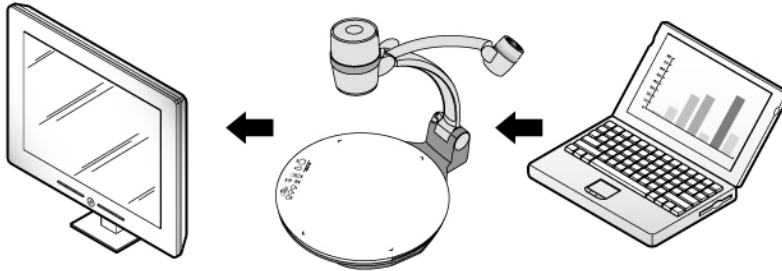

■ If you connect computer through VGA IN port, you can receive video signal from the computer.

Connection

Connect the cable to the VGA input terminal

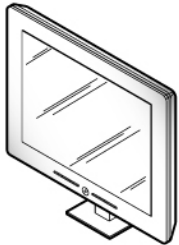

PC monitor, projector, etc.

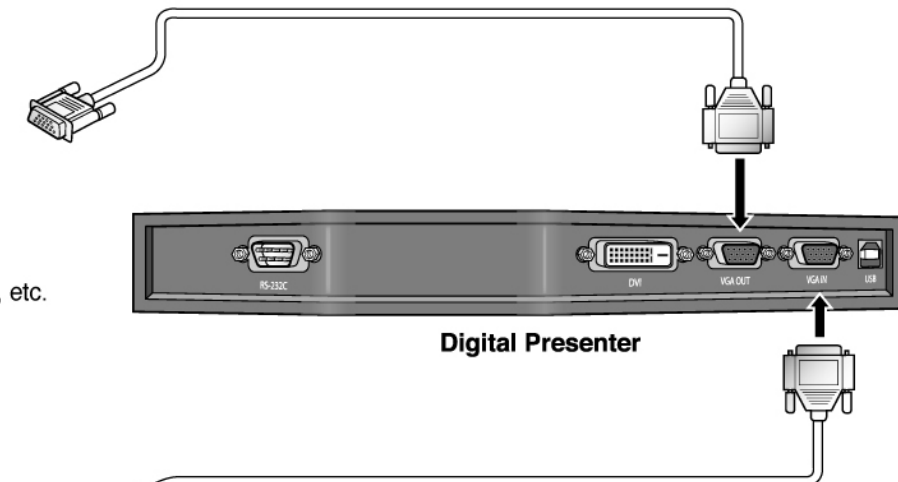

Digital Presenter

Connect the cable to VGA IN terminal using the VGA cable from the computer.
VGA IN terminal is available.

Connect the cable to VGA port on the computer equipped with XGA, SXGA, UXGA graphic card.

NOTE

Bypass : When you Power off the presenter, you can receive video signal from the VGA IN port.

Using the presenter

To show the image received from external device

1

Set up your digital presenter properly.
(See page 14.)

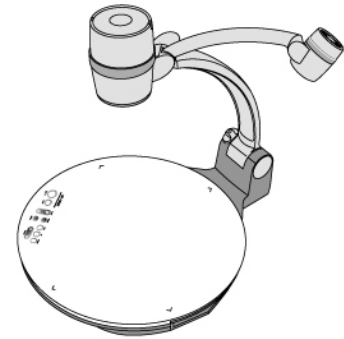

2

Connect the input device from which you want to receive the image and the output device in which you want to show the image.
(See pages 15 through 17)

3

Turn the power off the input and output device on, and the digital presenter on.

Using the presenter

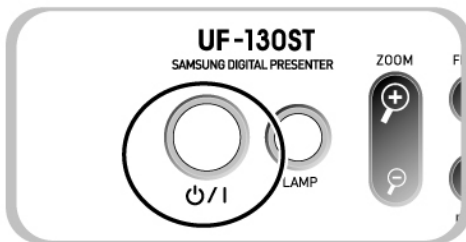

NOTE

When the digital presenter is powered on, the upper lamp turns on.
To turn off, press LAMP button of the presenter.

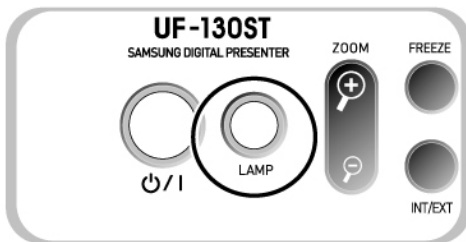

Using the presenter

4

Choose the video source with the **INT/EXT** button of the presenter.

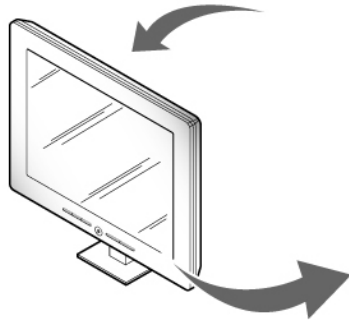
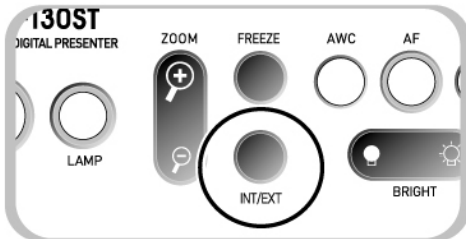

- Each time you press the button, the display shows EXT OUT, INT OUT
- **EXT OUT**
View the image from an external VGA output device through a PC monitor or a projector connected to the digital presenter.
- **INT OUT**
Choose this mode to show the image through the lens of the digital presenter.

NOTE

- If Blank Image is displayed, check if the external input device is connected properly.
- Although you select INT or EXT, the current status is not displayed.
- By DVI port you cannot receive the image from external device.

5

Open the image on the computer. Now you see the image through a PC monitor or a projector.

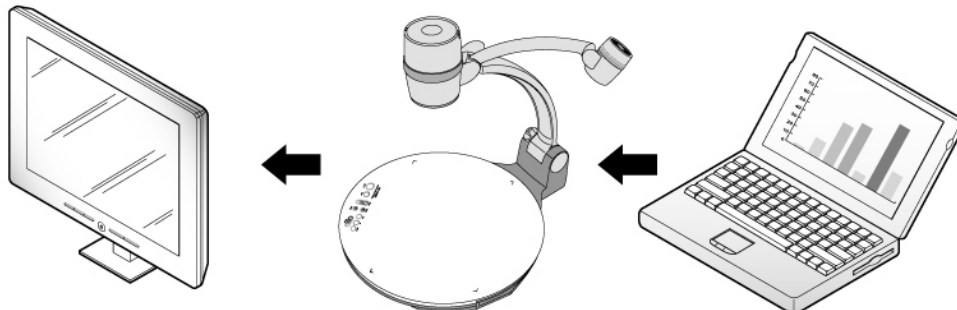



Adjusting your image

Use the control buttons on the remote control, on the control panel of the presenter or the control panel on the Live Viewer (desktop) to adjust the projected image. Some of the main features are described below :

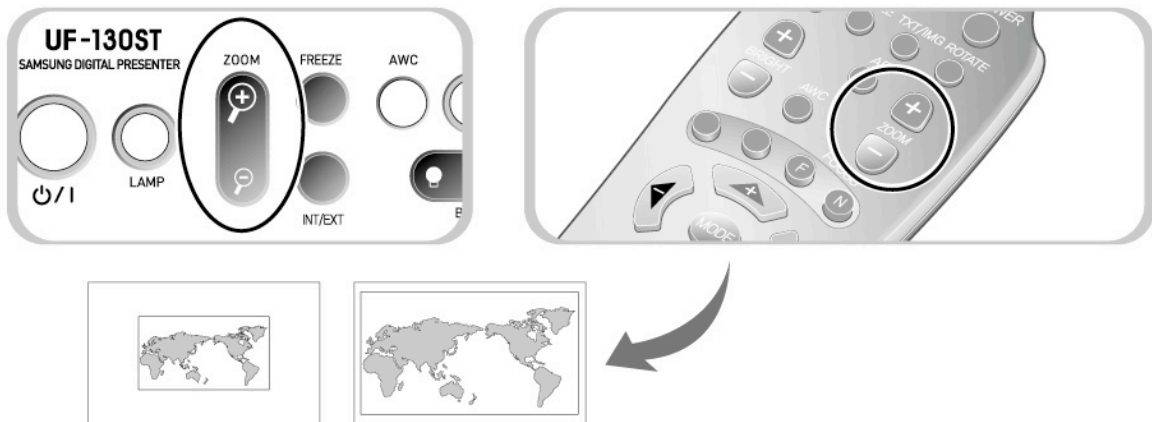
Adjusting image size



- ▼ Press WIDE or TELE button on the remote controller, the control panel on the Live Viewer (desktop) or the control panel on the Live Viewer (desktop) to change the image size displayed on the screen.
- ▼ You can also use ZOOM  , ZOOM  button of the presenter or the control panel on the Live Viewer (desktop) to achieve the same result.

Adjusting brightness

- ▼ Press BRIGHT  button on the control panel, BRIGHT + button on the remote control or the control panel on the Live Viewer (desktop) to lighten the overall image.
- ▼ Press BRIGHT  button on the control panel, BRIGHT - button on the remote control or the control panel on the Live Viewer (desktop) to darken the overall image.



NOTE

- In case of presenting glazed photograph, turn off the upper lamp and press  button of the control panel or BRIGHT- button of remote controller.

Adjusting your image

Adjusting image color

- ▼ For automatic color adjustment, press AWC button.
- ▼ If you want fine level adjustment, press BLUE+/- or RED +/- button on the remote controller or Live Viewer Panel to increase or decrease blue or red color factor manually.

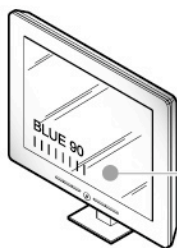
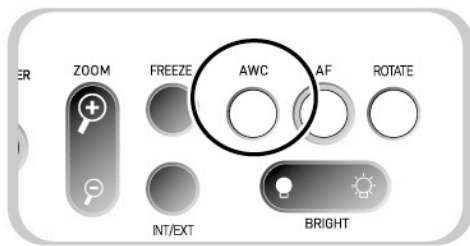

The color level will be displayed.

Hint

To obtain the best result, place a sheet of white paper under the lens and press the AWC button.

Adjusting your image

Image sharpness control

- ▶ Press TXT/IMG button on the remote control or Live Viewer Panel to control the sharpness of the output image.

TEXT MODE: Select the Text mode when displaying documents comprised mostly of text. Adjust the brightness to obtain the best result and automatically store the setting.

IMAGE MODE: Select this mode when display items such as photographs and 3-D objects. Adjust the brightness to automatically store this setting in the remote.



Adjusting your image

Image rotate control

- ▼ For image rotation, press **ROTATE** button.
To rotate the image by 90°, 180°, 270°, 0°, press ROTATE button

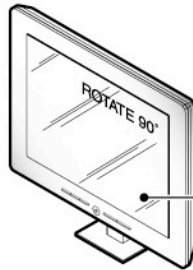
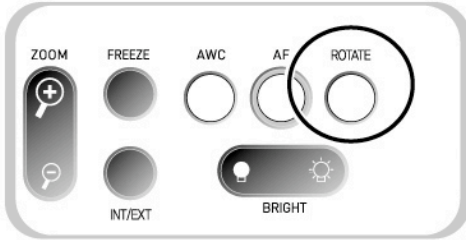

The rotate image status will be displayed.

Adjusting your image

Saving custom user setting

- After you adjust feature value, you can save the value for next time use. You can save up to 4 different custom user settings. (You can save the setting on the Zoom, Focus, Iris, Lamp state and Color level buttons.)



- ◀ To save the current value, press **SAVE** button and specify the memory location within 4 seconds using the number keys from 1 through 4.
- ◀ To recall your custom setting, press the **ACTIVE** button and press the memory location number within 4 seconds.

The memory location numbers are printed on the top side of these buttons. For example, if you want to save the feature into memory location 4, press SAVE then press 4 button on the top side of the **SAVE** button.

NOTE

You can not save the setting on the **FREEZE** and **ROTATE** functions.

Storage

1 Turn the power off and unplug the power cord.

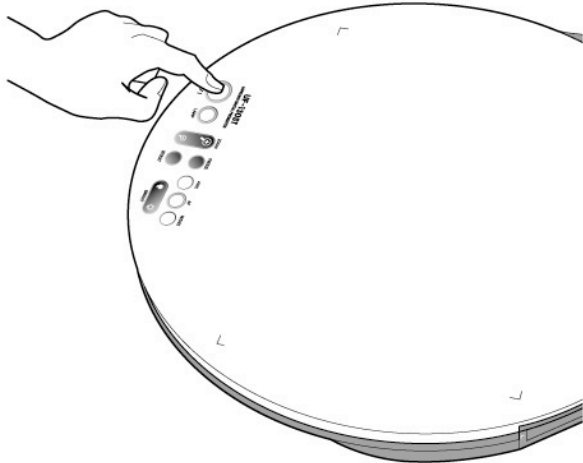

2 Attach the lens cap.

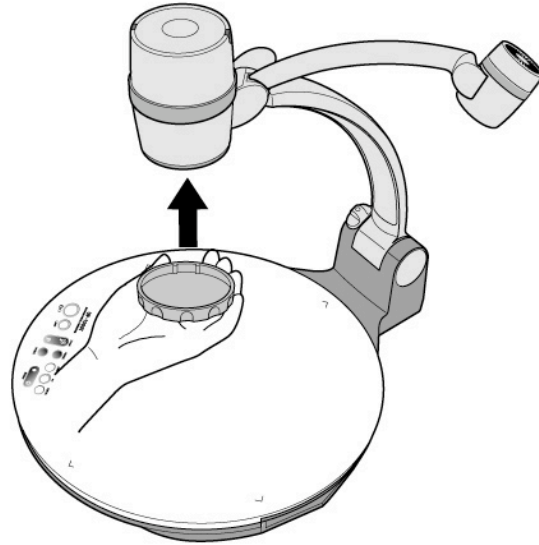

3 Turn the head upside down.

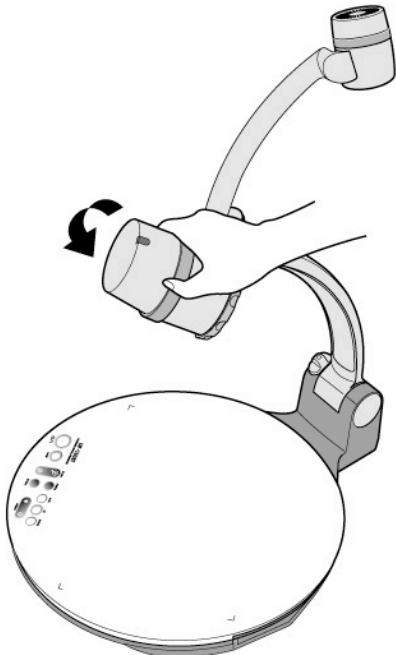

4 While you push the main lock button toward the front of the presenter, fold the arm shaft completely.

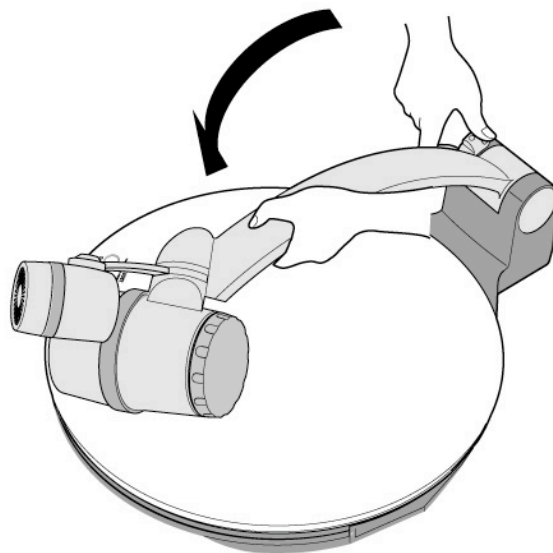

Storage

Storage

- 5 Fold lamp arm opposite lens part.

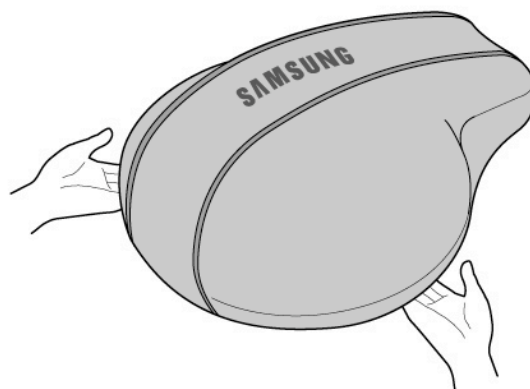
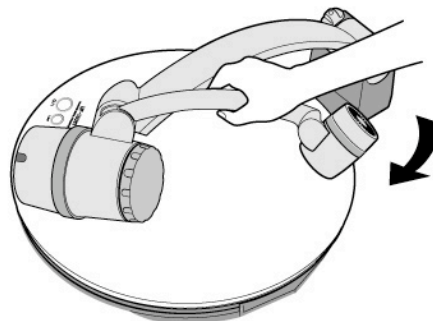

If you plan to store your Samsung UF-130ST for a long period of time, protect it with the supplied cover.

Trouble shooting

? No image appears

- ! - Check if the input selection of the output device is appropriate.
- ! - Check if the iris control is adequate.
- ! - Check if the VGA cable is connected to the VGA output terminal correctly.
- ! - Check if the lens cap is removed.

? No communication between the PC and USB.

- ! - Make sure the operating system is Windows 2000 or later. The software doesn't support Windows 98.
- ! - For other detailed information, please refer to the program manual supplied with the product.

? The image is out of focus.

- ! - Make sure the adaptor lens is attached.
- ! - Check if the distance from the object is too short.

? The mouse does not work normally.

- ! - Check the contact condition of mouse port.

? Remote control does not work

- ! - Check the batteries in the remote control.
- ! - Replace them with new ones.

If there are problems,
please contact the
supplier nearest you.



Battery replacement

1 Open the battery compartment lid on the back of the remote controller.

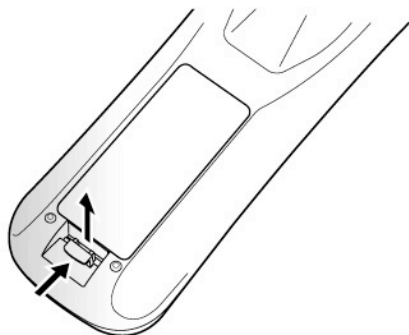

2 Insert new batteries.

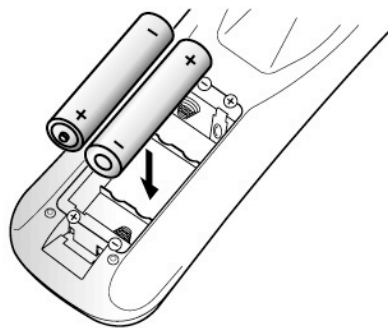

3 Close the lid.

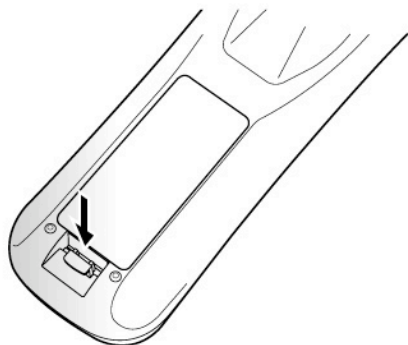

Specifications

■ Note : Specifications are subject to change without notice.

Mode		UF-130ST
Optical System	Lens	F=1.5(Wide) ~ 2.1(Tele) f=4.8 ~ 67.2
	Shooting Area	Max : 298 x 221mm, Min : 21.7 x 16.4mm
	Zoom	Powered (14x Optical), Digital (3x)
	Focus	Auto focus / Manual
	Iris	Auto (with fine level adjustment)
Illumination System	Upper	Power LED Illumination System
	Lower	Light Box (Option)
Video	Pick-up Device	1/3" Progressive Scan CCD
	Total Number of Pixels	1,348(H) x 976(V), 1.32M pixels
	Number of Effective Pixels	1,296(H) x 966(V), 1.25M pixels
	Frame Rate	SXGA/XGA : 22.5fps, 720p HD : 30fps
	VGA Output	SXGA (1,280 x 1,024), XGA (1,024 x 768), HD (1,280 x 720)
	White Balance	AWC (One-touch) / Manual
	Image Freeze	Available
	Image Rotation	Available (90°, 180°, 270°, 0°)
	Preset Function	Up to 4 user settings
	Input Selection	2 channels (Internal : 1, External : 1)
Interface Port	Input Port	VGA In 15 pin DSUB Connector x 1
	Output Port	VGA Out 15 pin DSUB Connector x 1
		DVI Out DVI-D type Connector x 1
	I/F Port	RS-232C 9 pin DSUB Connector x 1
		USB USB Slave B-type x 1
	Power Port	Power Input DC +12V In x 1
Power Output DC +12V Out x 1 (0.6A)		
General	Operating Temperature	+5°C ~ +35°C
	Operating Humidity	30% ~ 90%
	Power	12V DC (Adaptor input : AC 100V ~ 240V free voltage, 50/60Hz, output : 12V, 4A)
	Dimensions	In-use : Ø404(W) x 489(H) x 504(D)mm / Ø15.91"(W) x 19.23"(H) x 19.84"(D)
		Storage : Ø404(W) x 207(H) x 504(D)mm / Ø15.91"(W) x 8.15"(H) x 19.84"(D)
	Weight	About 5Kg (11.02 lb)
Accessories	Carrying bag, Remote controller, Cable, etc.	



Memo

Handwriting practice area with horizontal dotted lines.

Memo

Memo

A series of horizontal dotted lines for writing a memo.

Memo



Memo

Handwriting practice area with horizontal dotted lines.

Memo

Memo

A series of horizontal dotted lines for writing a memo.

Memo



SAMSUNG TECHWIN

SAMSUNG TECHWIN CO., LTD

SAMSUNG TECHWIN CO., LTD

145-3, Sandaewon-dong, Jungwon-gu, Seongnam-si, Gyeonggi-do, 462-120, Korea
TEL: +82-31-740-8160 FAX: +82-31-740-8145

SAMSUNG OPTO-ELECTRONICS UK, LTD.

Samsung House, 1000 Hillswood Drive, Hillswood Business Park, Chertsey, Surrey, KT16 0PS
TEL: +44-1932-45-5308 FAX: +44-1932-45-5325

SAMSUNG TECHWIN AMERICA. LTD.

1480 Charles Willard St. Carson, CA 90746, UNITED STATES
TEL: +1-310-632-1234 FAX: +1-310-632-2195

www.samsungtechwin.com
www.samsungpresenter.com

P/No.: Z6806.0939.01A